

SALOP.

PENTRECEFN, LLANSILIN,

3 $\frac{1}{2}$ miles from Oswestry.

Plan and Particulars

— OF —

Desirable FREEHOLD FARM and LANDS,

CALLED

“PENTRECEFN.”

Messrs. Whitfield and Sons

WILL OFFER FOR SALE BY AUCTION,

AT THE BELL INN, OSWESTRY,

On Tuesday, the 14th day of March, 1905,

At 4 o'clock in the afternoon precisely, and subject to conditions to be then produced.

PENTRECEFN, LLANSILIN,

IN THE COUNTY OF SALOP.

on and Particulars
OF DESIRABLE
FREEHOLD FARM and LANDS,
CALLED
“PENTRECEFN”

To be offered for Sale by Public Auction,
BY

Messrs. WHITFIELD and SONS,

AT THE BELL INN. CHURCH STREET,
OSWESTRY,

On TUESDAY, the 14th day of MARCH, 1905,

At 4 o'clock in the Afternoon precisely

(SUBJECT TO CONDITIONS).

MINSHALLS, PARRY-JONES & PUGH,

OSWESTRY.

Lot 3.

A Small Piece of Pasture Freehold Land,

Close to Lot 2, also in the Parish of Llansilin, with a frontage to the main Road, containing 0a. 3r. 3p. or thereabouts, in the occupation of Mr. Robert Morris.

Reference.

NO. ON PLAN.	DESCRIPTION.	CULTIVATION.	QUANTITY.		
			a.	r.	p.
125	Batten back	Pasture	0	3	3

Further particulars may be had from the Auctioneers, Church Street, Oswestry, or from

MESSRS. MINSHALLS, PARRY-JONES AND PUGH,
SOLICITORS, OSWESTRY.

PARTICULARS.



Lot 1.

ALL THAT DESIRABLE FREEHOLD FARM AND LANDS,

CALLED

“PENTRECEFN,”

Situate in the Parish of Llansilin, in the County of Salop, in the occupation of Mr. Robert Morris, and containing by admeasurement 33a. 3r. 4p. or thereabouts, of **Arable and Pasture Land**. The Dwelling-house contains Kitchen, Parlour, Milk-house, Pantry, and 3 Bedrooms, Cowties for 10, Stable, Barn, Bays, Pigsty, and other Buildings.

Reference.

NO. ON PLAN.	DESCRIPTION.	CULTIVATION.	QUANTITY.		
			a.	r.	p.
284	Little Field above house	Pasture	2	0	37
288	House, Buildings, &c.	...	0	1	29
289	Field	Pasture	5	0	32
250	Fordd Fawr	Do.	1	0	35
253	Erw Gam and Rough	Arable	2	3	22
254	Cae Mawr	Do.	3	0	23
255	Cae Canol and Rough	Do.	3	1	7
295	Cae Issa	Do.	3	2	39
296	Cae Glyb and Cae Maen	Pasture and Arable	4	1	27
297	Cae Tyn Twll	Pasture	1	0	13
298	Little Field	Arable	1	0	13
141	Vownog	Pasture	5	0	7
TOTAL			33	3	4

The House, Buildings and Farm are in good Condition, most conveniently arranged and up to good roads. The farm is surrounded by Lands belonging to G. J. Dumville Lees, Esq., and Lady Williams Wynn. The Timber on this Lot is taken to at a valuation to be declared at the time of sale.

There is a stream of water running through a portion of Lot 1.



Lot 2.

All Those three Pieces of Freehold HILL PASTURE LAND,

Overlooking the Village of Llansilin, part of Pentrecefn Farm, in the occupation of Mr. Nathaniel Hughes, and containing by admeasurement **20a. 0r. 26p.**, or thereabouts.

Reference.

NO. ON PLAN.	DESCRIPTION.	CULTIVATION.	QUANTITY.		
			a.	r.	p.
140	Mynydd Mawr	Pasture	6	3	14
127	Mynydd Canol	Do.	6	2	31
126	Batten	Do.	6	2	21
TOTAL			20	0	26

There is a continuous supply of Water on Lot 2. This Lot is surrounded by Lands belonging to Lady Williams Wynn, G. J. Dumville Lees, and C. H. Bull, Esquires.

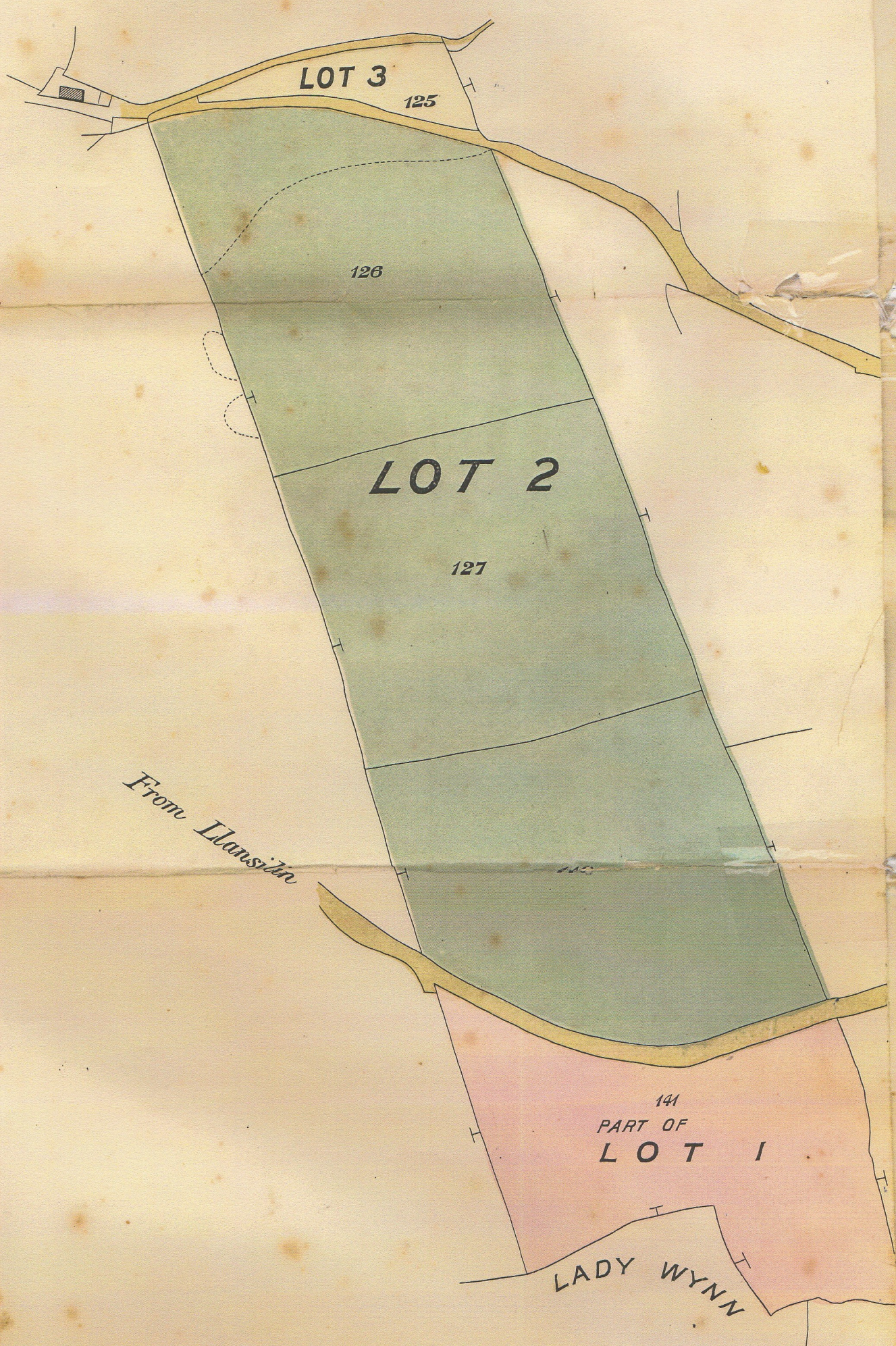

— Scale - 208.33 feet to an inch —